

2002-2010 MINI COOPER DYNAPRO BIG BRAKE FRONT HAT KIT

Models Covered:

BMW Mini Cooper	2002-2010
BMW Mini Cooper "S"	2002-2010

Kit Features:

- Full bolt-on installation
- Compatible with OE master cylinder output and ABS
- Use as-is with aftermarket, deep offset 16" or larger wheels
- Requires 1/8" thick wheel spacer to use OE 16" wheels

Component Features:

DynaPro Four Piston Radial Mount Calipers

- Rigid FEA designed billet body provides maximum clamping efficiency and unyielding pedal response by eliminating fluid volume displacement loss from structural deflection at the high output pressures generated by power brake master cylinders
- Four piston design generates high clamping force with balanced pad loading.
- Quick-Clip pad retainers allow fast and easy pad service without caliper removal.
- Spring loaded stainless steel SRS bridge plates reduce noise by damping engagement harmonics and stopping pad rattle. Bridge wear from gouging at the pad trailing edge is also eliminated.
- Internal fluid passages prevent all potential problems associated with external fluid transfer tubes.
- Four corner bleed screws accommodate effective gas evacuation regardless of mounting position.
- Radial mounting provides solid attachment with two planes of adjustment for precise alignment and simplified caliper service in the field.

SRP or HP Series 12.19" Diameter Rotors

- Increased diameter multiplies stopping leverage over OE diameter rotors.
- 32 vane vented iron design provides high cooling efficiency.
- SRP Series rotors are e-coated to resist corrosion and feature an engineered directional drill and slot pattern for an aggressive high tech appearance inside the wheel. The holes and slots enhance pad performance by reducing pad glazing and dispersing the gasses and some of heat generated during braking.
- HP series full surface rotors are precision machined at less than .001" for total parallelism, flatness, and run-out. This non-drilled version carries additional mass for increased thermal stability in sustained heat competition.

Forged Aluminum Rotor Mounting Hats

- Premium grade alloy forged aluminum hats are lightweight and provide sturdy mounting of the vented iron rotors over the OE hub assembly.
- High luster black anodized finish resists corrosion and enhances the custom appearance inside the wheel.

BP-10 Brake Pads with Noise Suppression Shims

- Each kit includes BP-10 compound "Smart Pads". BP-10 is a unique metallic composite compound that delivers quiet, low dust performance, but with the improve response, friction, and temperature range of a semi-metallic style pad.
- Viscoelastic multi-layered noise suppression shims provide additional damping of harmonic or resonant vibrations that generate pad squeal.

Mounting Hardware and Plumbing

- Machined billet radial mount brackets with all necessary high strength fasteners, washers, and alignment shims are included with each kit
- Optional flex line kits include stainless steel reinforced hoses with machine crimped ends and the fittings necessary to connect the calipers to the OE brake line fitting at the chassis. Flex line kits must be ordered separately.



**BMW Mini Cooper Big Brake
Front Kit**
Down Load High Resolution Photo,
[click here](#)

Please check the diagram on the back of this page for minimum inside wheel clearance requirements

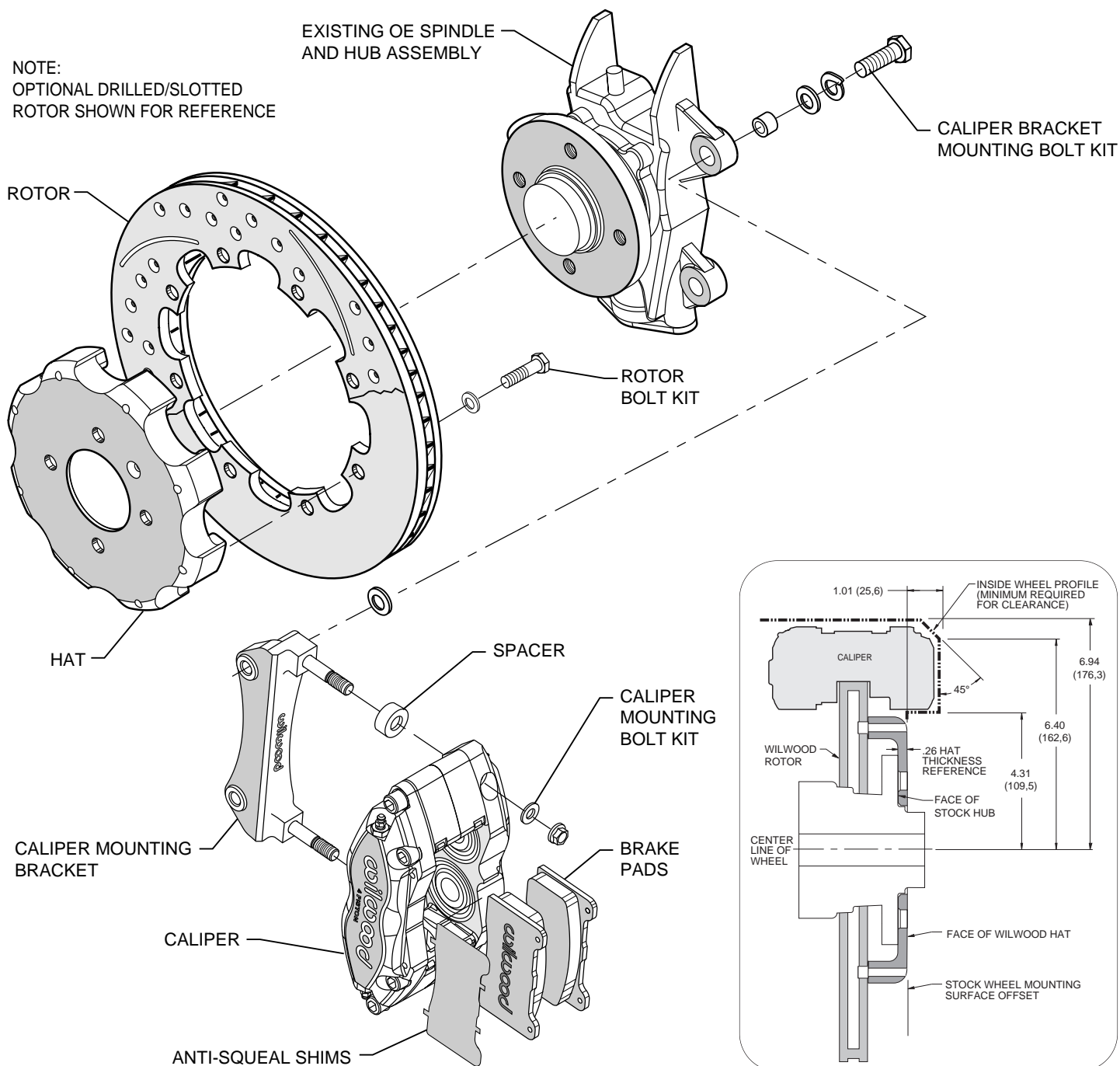

Typical Installation Diagram, Major Components Identified. Minimum Wheel Fit Dimensions Shown Inset

ORDERING INFORMATION:

PART NUMBER

DESCRIPTION

140-8528	Front Brake Kit, Mini Cooper, DynaPro Caliper, 12.19" HP Rotor
140-8528-D	Front Brake Kit, Mini Cooper, DynaPro Caliper, 12.19" SRP Drilled and Slotted Rotor
140-8528-R	Front Brake Kit, Mini Cooper, DynaPro Caliper, 12.19" HP Rotor, Red Caliper
140-8528-DR	Front Brake Kit, Mini Cooper, DynaPro Caliper, 12.19" SRP Drilled and Slotted Rotor, Red Caliper

2002-2010 MINI COOPER CPB REAR PARKING BRAKE KIT

Applications:

- Mini Cooper, Mini Cooper "S", 2002 - 2010 model years.

Kit Features:

- Combination hydra-mechanical parking brake calipers use hydraulic pressure for stopping and a mechanical lock for parking.
- 11.75" rotors provide improved stopping power, balanced rear bias, and competitive styling to compliment front brake upgrades in conjunction with wheel, tire, and suspension modifications.
- Caliper brackets and installation hardware are engineered specific for this kit.

Component Features:

Combination Hydra-Mechanical Parking Brake Caliper

- Single piston floating mount calipers are securely attached to the axle with a fixed radial mount bracket on the axle.
- The floating mount caliper maintains perfect alignment when the cable actuated mechanical parking brake lock is engaged and then released.
- Correct alignment is maintained over the disc as the pads wear and pad knock back is minimized on c-clip rear axles with measurable side play.
- Radial mounting provides secure attachment to the axle housing end and precise adjustments for pad to rotor alignment.
- The cable actuated parking brake is easily adapted to the original cable system on most vehicles. Cables for aftermarket hand brake lever kits are easily configured for custom fabricated installations.



**Combination Caliper Rear
Parking Brake Kit with SRP Rotor**
Down Load High Resolution Photo,
[click here](#)

HP Straight or SRP Directional Vane 11.75" Diameter x 0.81" Thick Rotors

- Whether straight or directional vane, these rotors provide the highest degree of cooling efficiency with increased surface area and improved air circulation between the rotor faces.
- HP rotors provide high performance and rugged durability for a wide range of competition, performance, sport driving and off-road applications. Rotors are cast from premium grade, long grain carbon iron.
- Drilled rotor kits feature our signature SRP performance drilled and slotted rotors with a durable e-coat finish. E-coat seals the casting and prevents corrosion in all areas of the rotor not swept clean by the brake pads. This durable finish will maintain the high tech styling and appearance of the rotors inside your wheels for many miles down the road.

GT Forged Aluminum Rotor Hats

- Premium grade alloy forged aluminum hats are lightweight to reduce rotating weight and strong to provide secure mounting of the disc over the OE axle flange.
- Black e-coat finish resists corrosion while adding to the aggressive competition look inside the wheel.

Wilwood BP-10 "Smart Pads"

- BP-10 metallic-composite compound "Smart Pads" run clean and quiet with improved friction, positive response, and higher fade resistance over all types of OE and street rated pad compounds.

Hardware and Plumbing

- Caliper brackets, premium grade fasteners, and alignment shims are included in every kit.
- Stainless steel braided DOT approved flexline kit is necessary and must be ordered separately, order part number 220-10879.
- Parking brake cable is required for functionally and must be ordered separately, order part number 330-10915.

WARNING
 INSTALLATION OF THIS KIT SHOULD **ONLY** BE
 PERFORMED BY PERSONS EXPERIENCED IN
 THE INSTALLATION AND PROPER OPERATION
 OF DISC BRAKE SYSTEMS.

NOTE
 SPECIFIC PARTS MAY VARY FROM DIAGRAM

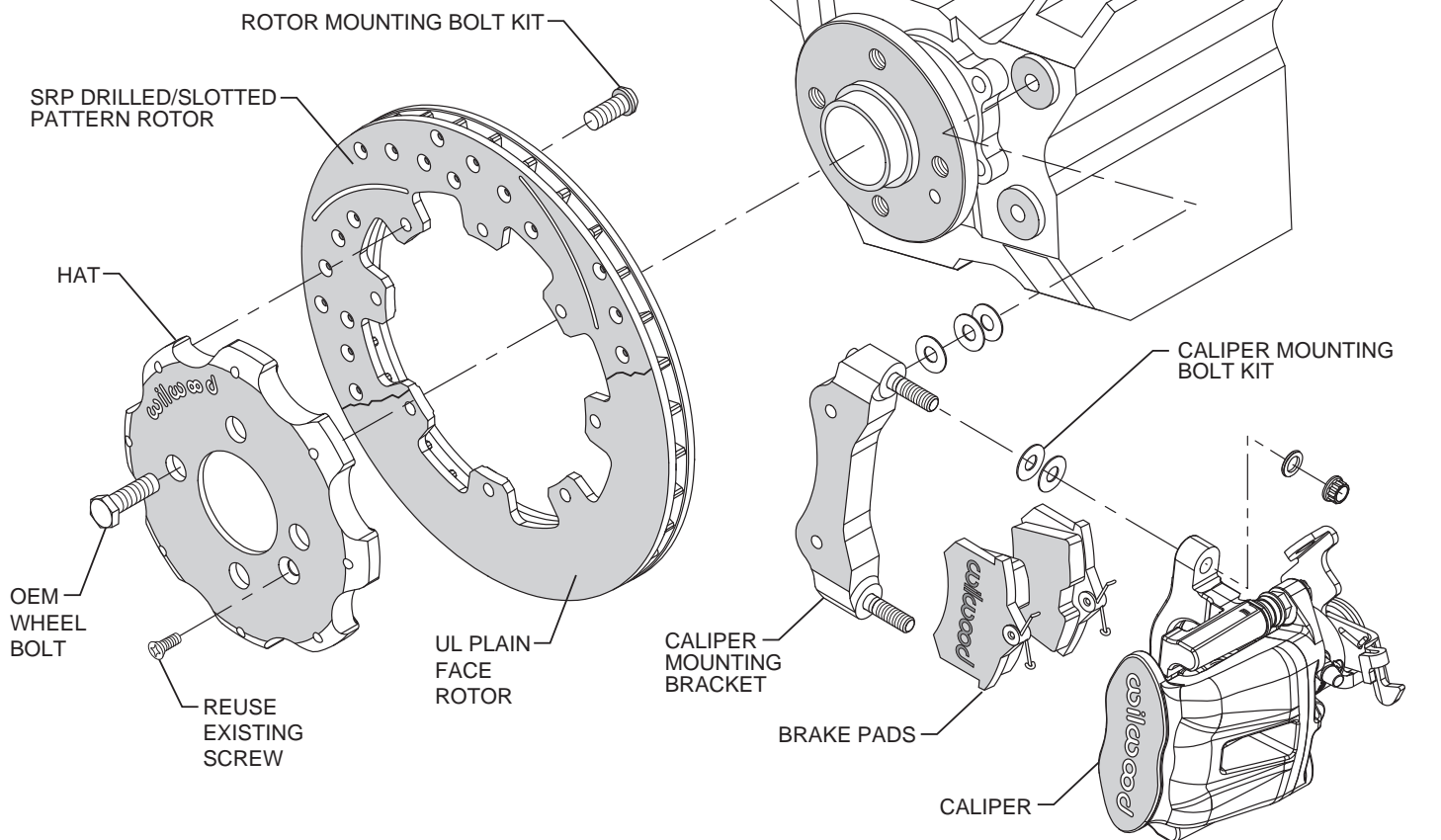

Typical Installation Diagram, Major Components Identified.

ORDERING INFORMATION:

PART NUMBER	DESCRIPTION
140-10885	Rear Parking Brake Kit, Mini Cooper, CPB Caliper, 11.75" HP Rotor
140-10885-D	Rear Parking Brake Kit, Mini Cooper, CPB Caliper, 11.75" SRP Drilled and Slotted Rotor
140-10885-R	Rear Parking Brake Kit, Mini Cooper, CPB Caliper, 11.75" HP Rotor, Red Caliper
140-10885-DR	Rear Parking Brake Kit, Mini Cooper, CPB Caliper, 11.75" SRP Drilled and Slotted Rotor, Red Caliper



Need additional information - fast? Utilizing your Smartphone, scan the image at the left to jump to our web site. This code takes you to our home page and social media sites where information is just a click away, [or click here.](#)